

Bihar Urban Infrastructure Development Corporation

(Government of Bihar Enterprise)



Request for Proposal

for

**EMPANELMENT FOR SUPPLY AND CONSTRUCTION OF
PREFABRICATED COMMUNITY & PUBLIC TOILETS
FOR ULBs IN BIHAR UNDER RATE CONTRACT**

VOLUME-2 of 3

SCHEDULE OF SUPPLY



BUIDCo office, Khadya Bhawan, 2nd floor, Daroga Prasad Rai Path, R. Block Road No.-2, Patna-800 001

(Tel: 0612-2506109/208, Fax No.-0612-2506132 Email: tenders@buidco.in)

SECTION III - SCHEDULE OF SUPPLY AND CONSTRUCTION

1. Community Toilets (6 Seater) for Ladies & Gents.

S. No	Equipment/Goods
1	supply and construction of Community Toilets & Public Toilets for Ladies & Gents with prefabricated materials using Prefabricated Technology of "Continuous PUF Sandwich Panel fixed to Tubular Steel Frame".



1 Delivery and Completion Schedule

Delivery of Goods and Related Services should be carried out as per provisions of Purchase Order which may be issued by the Purchaser time to time for such quantity as may be required by the concerned Urban Local Bodies in Bihar or any other department in Bihar.

Technical Specification – Supply and construction of Community Toilets 6/9 Seater for Ladies & Gents with prefabricated materials using Prefabricated Technology of “Continuous PUF Sandwich Panel fixed to Tubular Steel Frame”.

TECHNICAL SPECIFICATION FOR PUF INSULATED PREFABRICATED TOILET BLOCK

Description :

The prefabricated toilet blocks shall be suitable for mounting on readymade concrete floor / pillars. The components shall be fabricated at factory for easy to assembly at site.

Size :

- a) **Community Toilet (6 Seater) : 5.0 x 3.0 x 2.4 mt**
- b) **Community Toilet (9 Seater) : 5.0 x 3.0 x 2.4 mt**

M.S. Structure :

The supported M.S. Structure like column, truss / portal truss, purlin, tie member etc. shall be made out with suitable size rolled / tube / folded sections. The structure shall be painted with One coat of red oxide as primer and two coats of good quality oil paint

PUF Insulated wall :

The insulated walls shall be made of Sandwich panels. The sandwich panels shall be made out of 0.35mm thick Pre coated steel sheet (white colour) on both side of PUF (Polyurethane foam). The total thickness of panel shall be 30mm. The panels are join together by tongue and groove method.

PUF Insulated Roof :

The insulated Roof cladding shall be done with sandwich type panels. The panels shall be made out with 0.35 mm thick Pre coated Profile steel sheet (Teracotacolour) at outer side and 0.35 mm thick Pre coated sheet (White colour) at inner side of PUF (Polyurethane foam). Total thickness of roof panel shall be 20 mm. Suitable ridge shall be made out from Pre coated steel sheets. The roof shall have minimum projection of 0.3m from the eaves wall and 0.15m from the gable walls.

Door :

The door frame shall be made out with MS Folded section. The shutter shall be made out with Pre coated steel sheets both side of PUF as per wall panel. The door shutter shall be fixed with the door frame with hinges. The door shutter shall be provided with 1 No. aldrops at outside, 1 no. Tower bolts at the center inside and handles shall be provided on both the sides. The size of door shall be as per mention in drawing.

Air Ventilator :

The air ventilator shall be made out from readymade Aluminum Adjustable louvers type channels.and it will be fixed in the wall panels with suitable fasteners. Suitable plain glass shall be provided as a louvers. The size of air ventilator shall be as per mention in the drawing.

Technical parameters : Foundation Section Details of 6 seater Community Toilets

The Section details for the said Supply and construction of Community Toilets for Ladies & Gents with prefabricated materials using Prefabricated Technology will be as follows

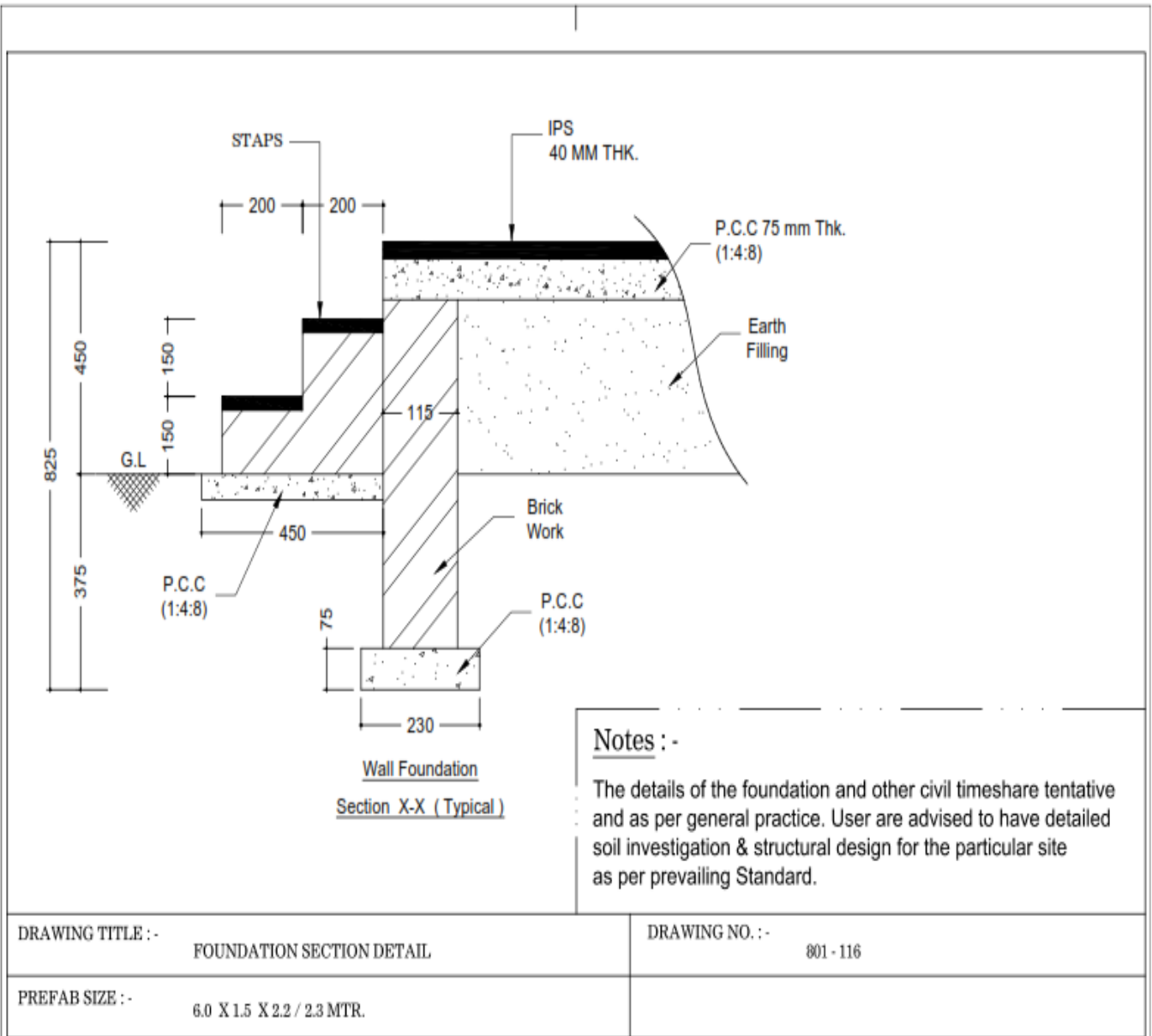

Technical parameters : Foundation Plan Details of 6 seater Community Toilets

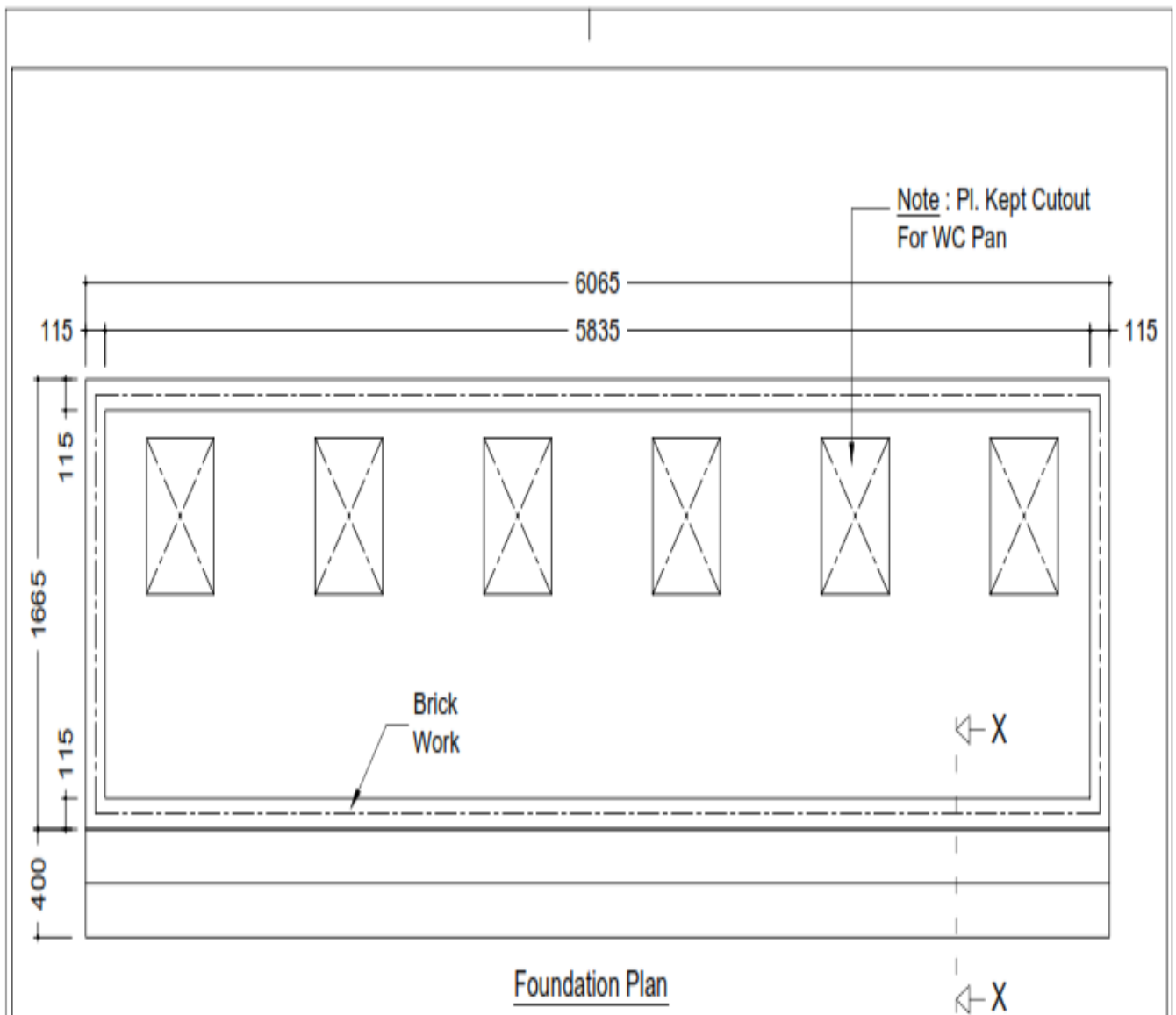

DRAWING TITLE :- LAY OUT OF FOUNDATION DETAIL

PREFAB SIZE :- 6.0 X 1.5 X 2.2 / 2.3 MTR.

Technical parameters : TOILET LAYOUT of 6 seater Community Toilets

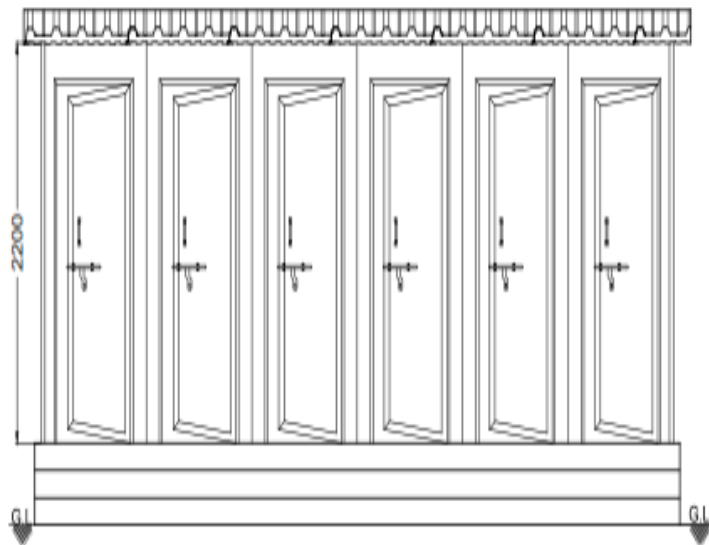

ELEVATION

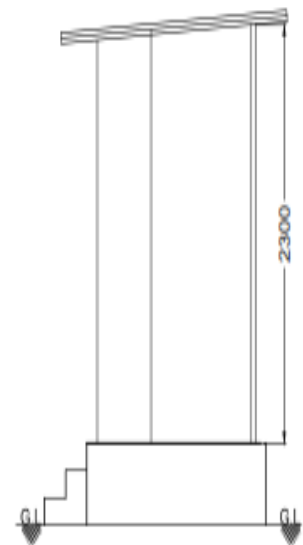

RIGHT SIDE VIEW

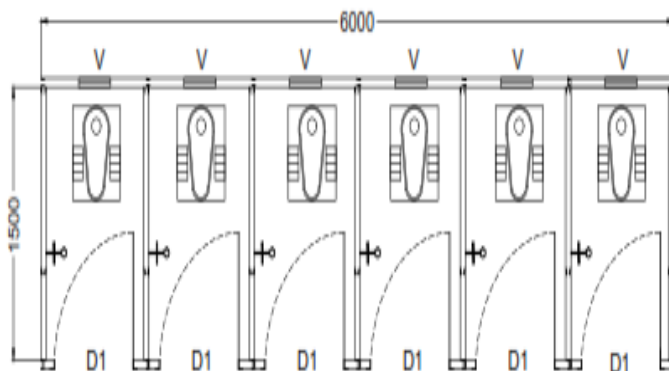

PLAN

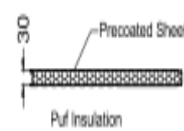

TYP. WALL SECTION



TYP. ROOF SECTION

EACH W.C SIZE IS : 1.0 x 1.5 mtr.

DOOR & VENT SCHEDULE		
MARK	ITEM	OPENING SIZE IN MM
D1	DOOR	750 x 2000
V	VENT	400 x 450

NOTE:-

THE DIMENSION, STRUCTURE & THICKNESS SHOWN ARE INDICATIVE & MAY CHANGE TO SUITE DEFINED DRAWING.

DRAWING TITLE :-
 PREFABRICATED W.C BLOCK

PREFAB SIZE :-
 6.0 X 1.5 X 2.2 / 2.3 MTR.

Technical parameters : Plumbing Details of 6 seater Community Toilets

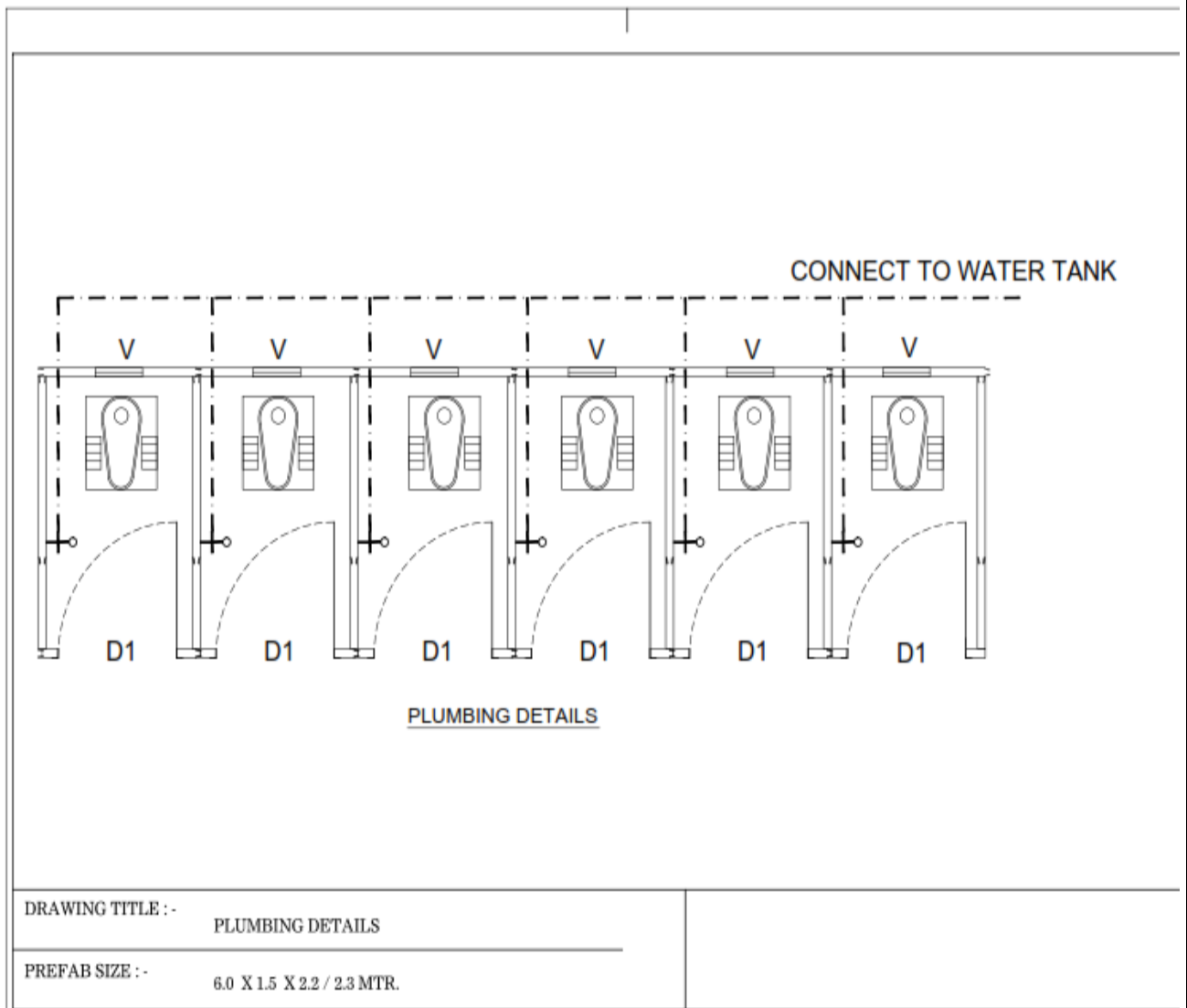

Technical parameters : Septic Tank Details of 6 seater Community Toilets

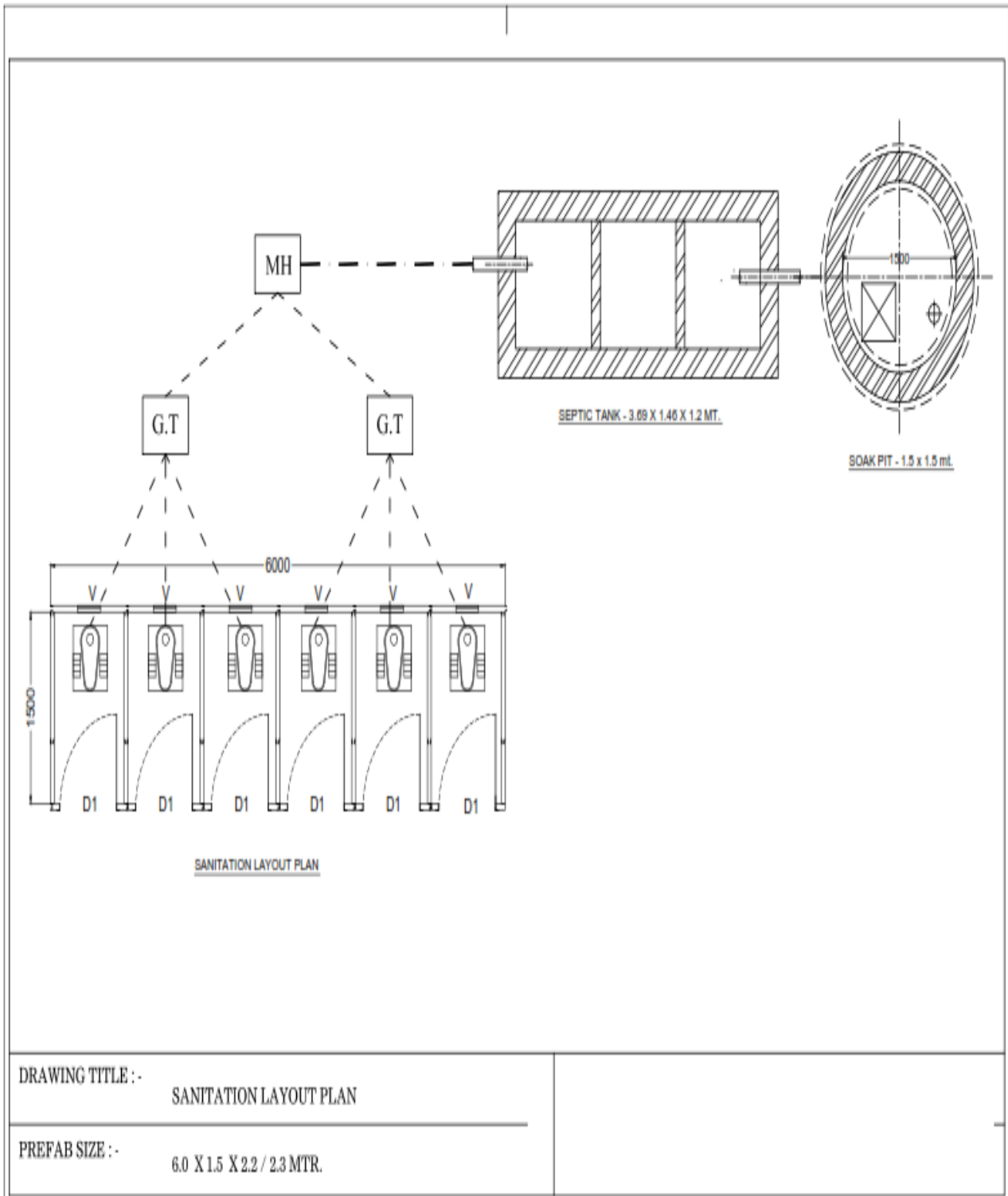

Technical parameters : Septic Tank of 6 seater Community Toilets

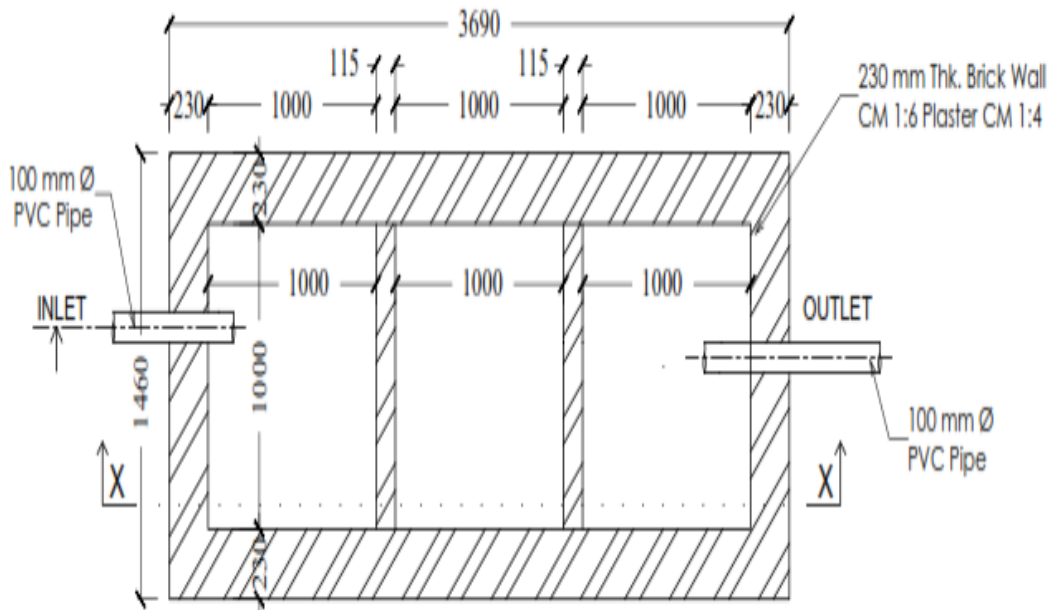

PLAN

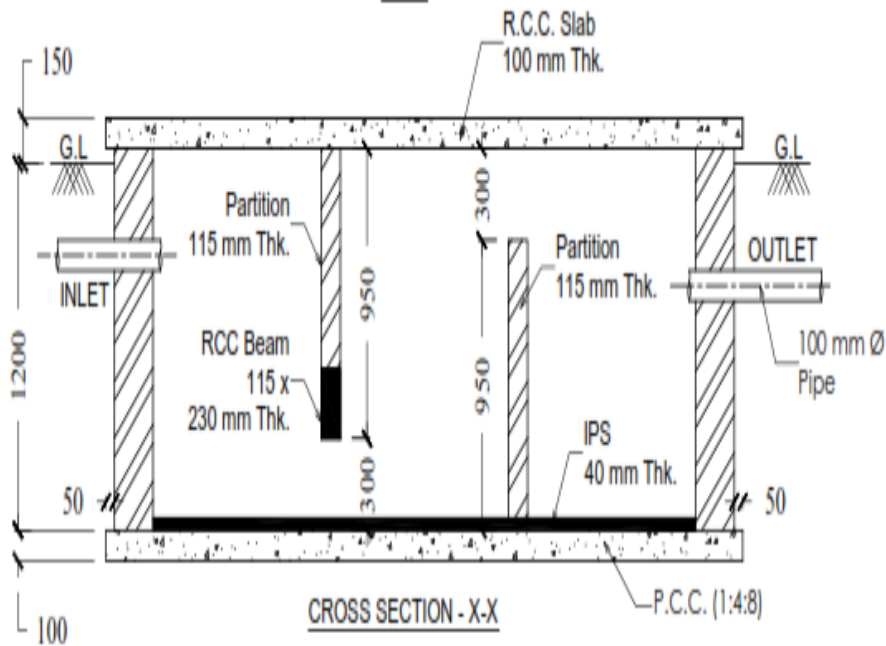

CROSS SECTION - X-X

DRAWING TITLE :- SEPTIC TANK

PREFAB SIZE :- 3.69 X 1.46 X 1.2 MT.

Technical parameters : Soak Pit details of 6 seater Community Toilets

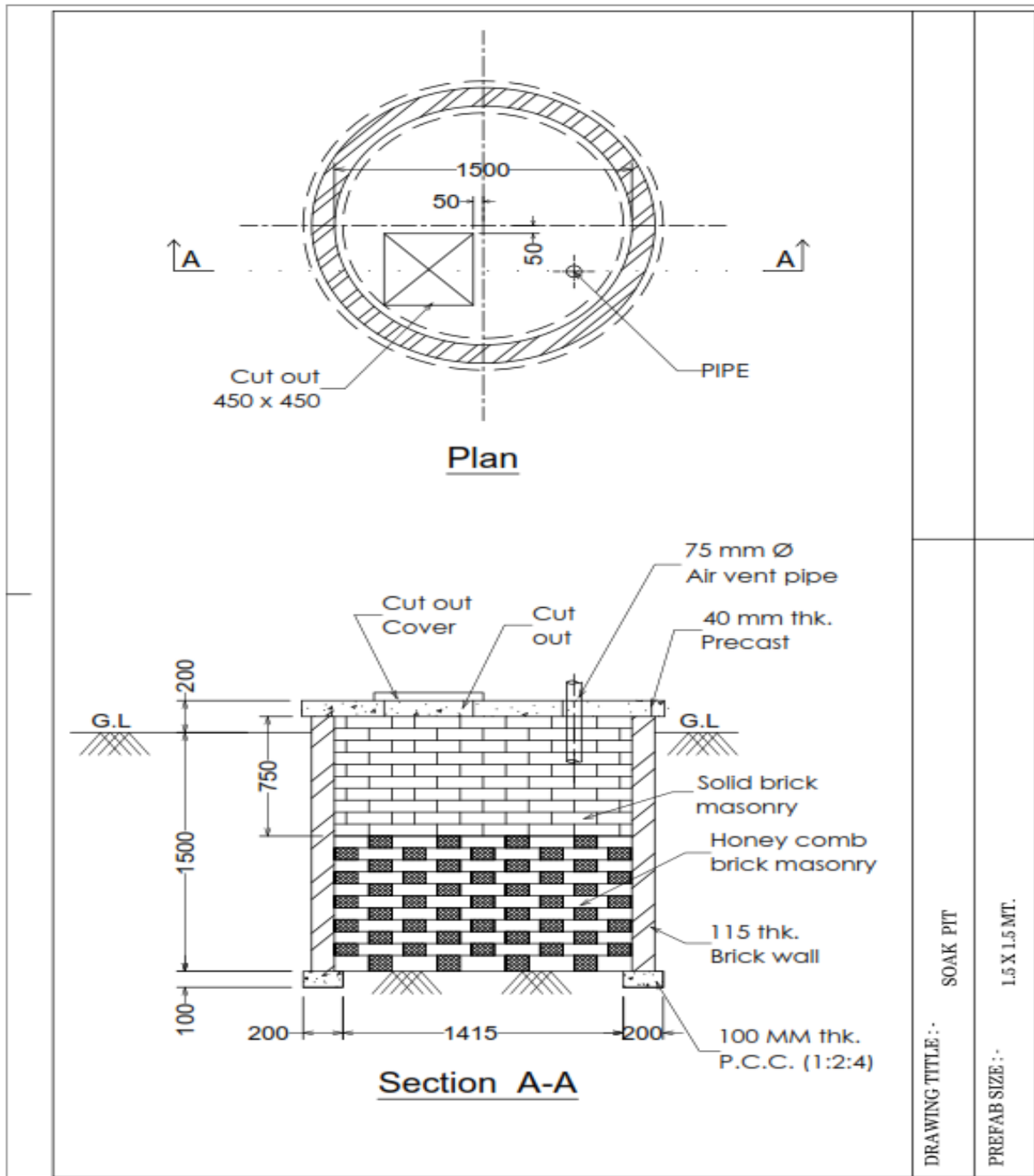

Technical parameters : Gully Trap of 6 seater Community Toilets

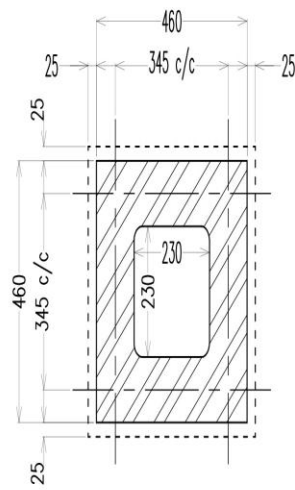
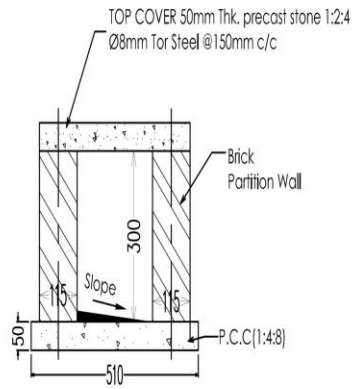

***NOTE :**

- Brick work mortar ratio (1:6)
- 10mm Thk. Finish plaster will be done inside of I.C. in Cm 1:4

DRAWING TITLE:-
GULLY TRAP - (GT)

DRAWING NO:-
801 - 314

PREFAB SIZE:-

UD & HD DEPT. - BIHAR

Technical parameters : Inspection Chamber of 6 seater Community Toilets

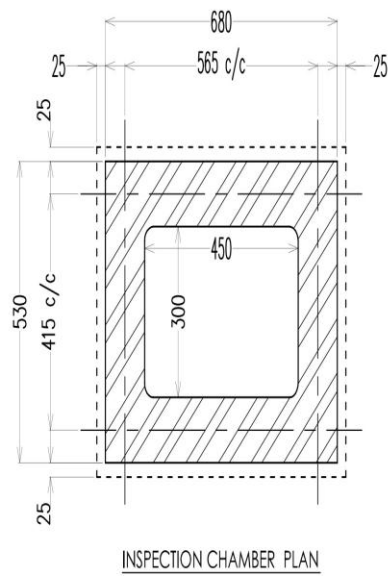
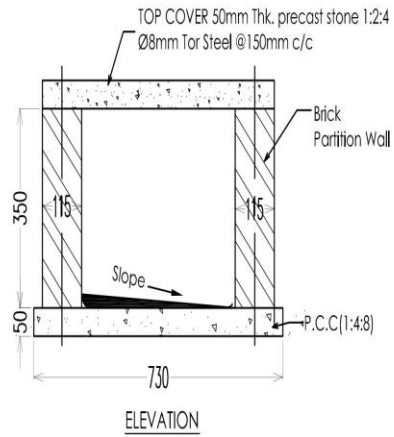

***NOTE :**

- Brick work mortar ratio (1:6)
- 10mm Thk. Finish plaster will be done inside of I.C. in Cm 1:4

DRAWING TITLE:- INSPECTION CHAMBER - (IC)	DRAWING NO.:- 801 - 313
PREFAB SIZE:- _____	UD & HD DEPT. - BIHAR

2. Community Toilets 09 Seater for Ladies, Gents and Children.

Technical parameters : Foundation Section Details of 9 Seater Community Toilets for Ladies, Gents and Children.

The Section details for the said Supply and construction of Community Toilets for Ladies ,Gents and Children with prefabricated materials using Prefabricated Technology will be as follows

1. Electrical Lay Out for (09 Seater) Community Toilets Block for ladies ,Gents and Children.

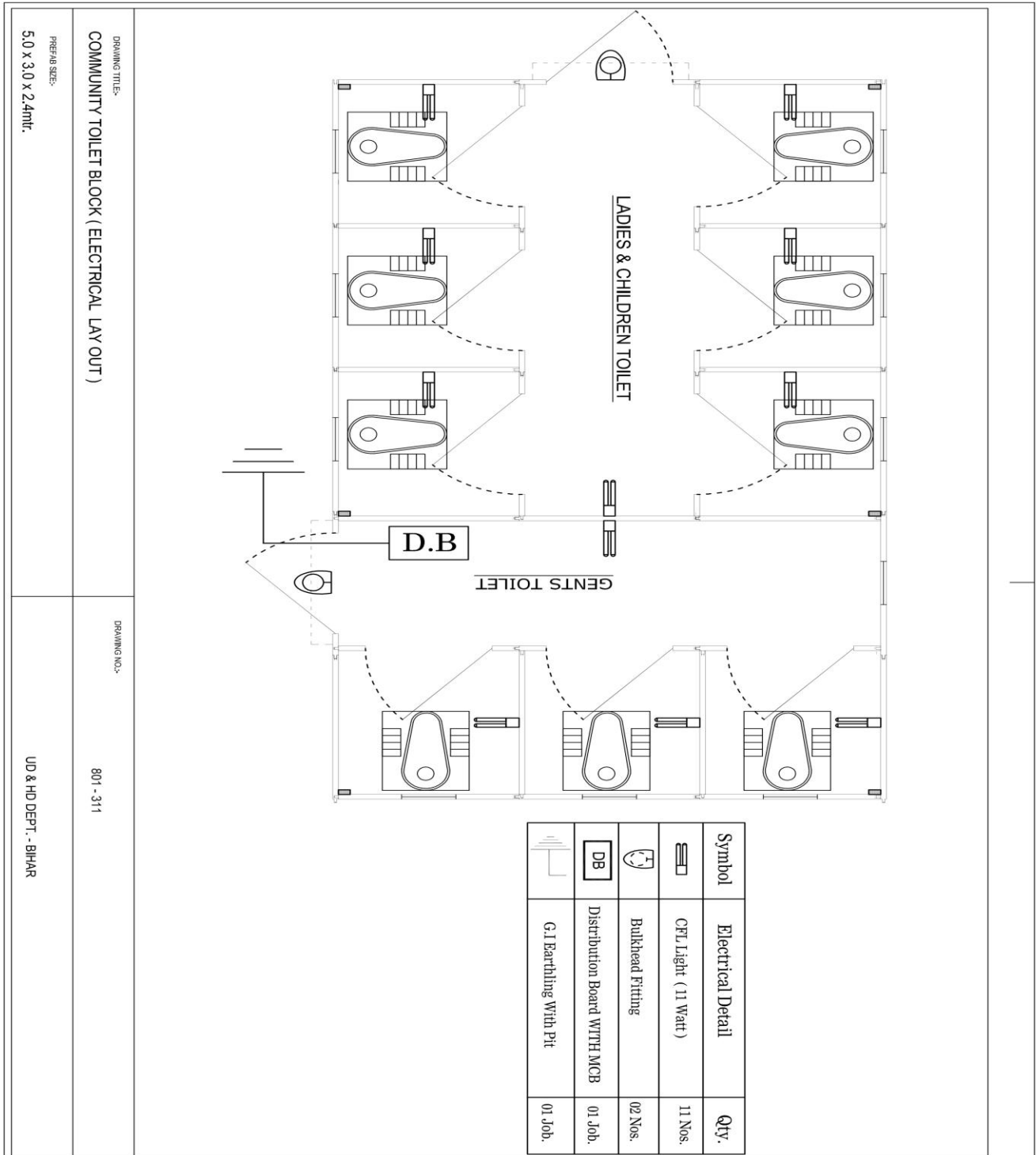

1. Foundation Layout for (09 Seater) Community Toilets Block for ladies ,Gents and Children.

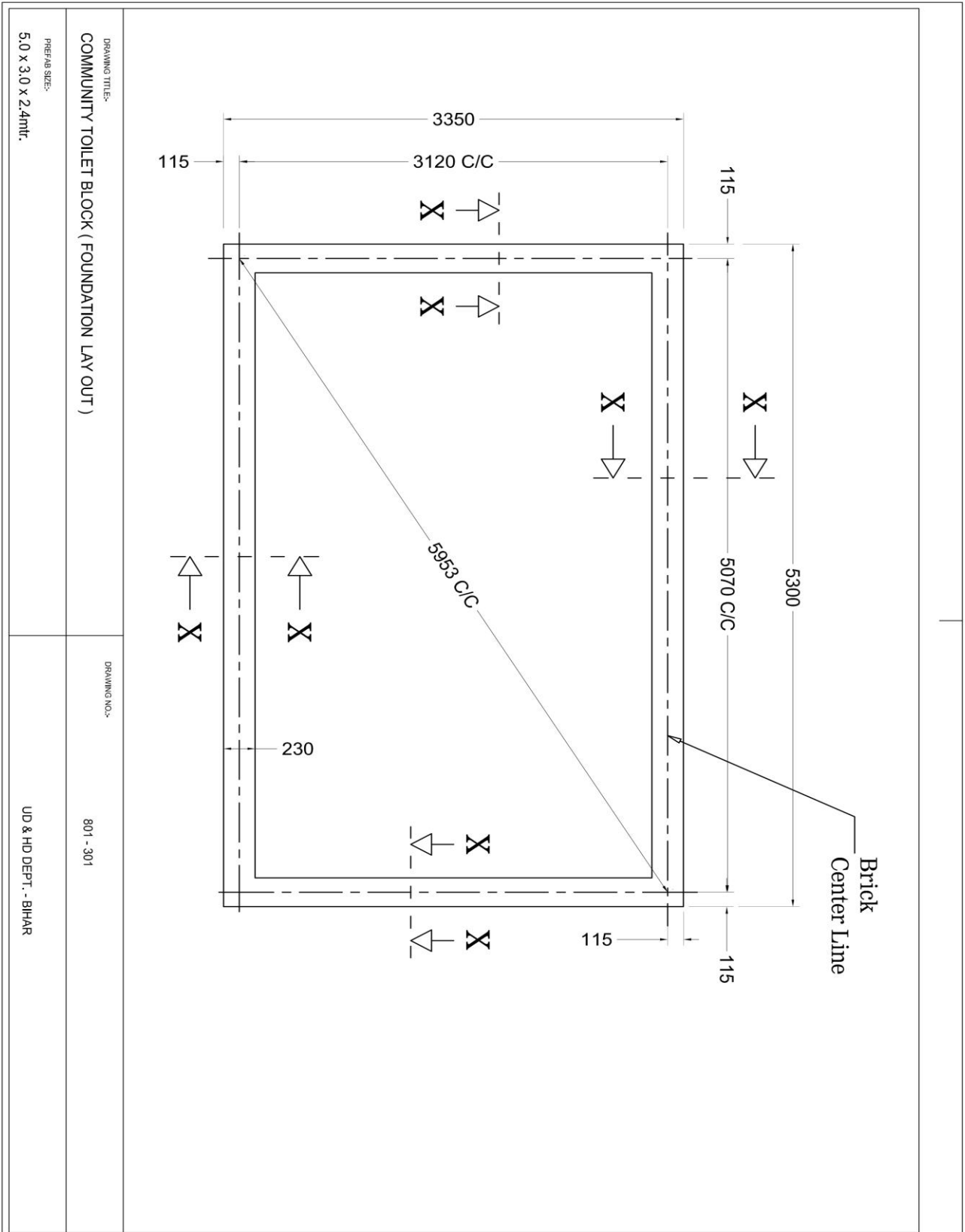

2. Plumbing Lay out for (09 Seater) Community Toilets Block for ladies ,Gents and Children.

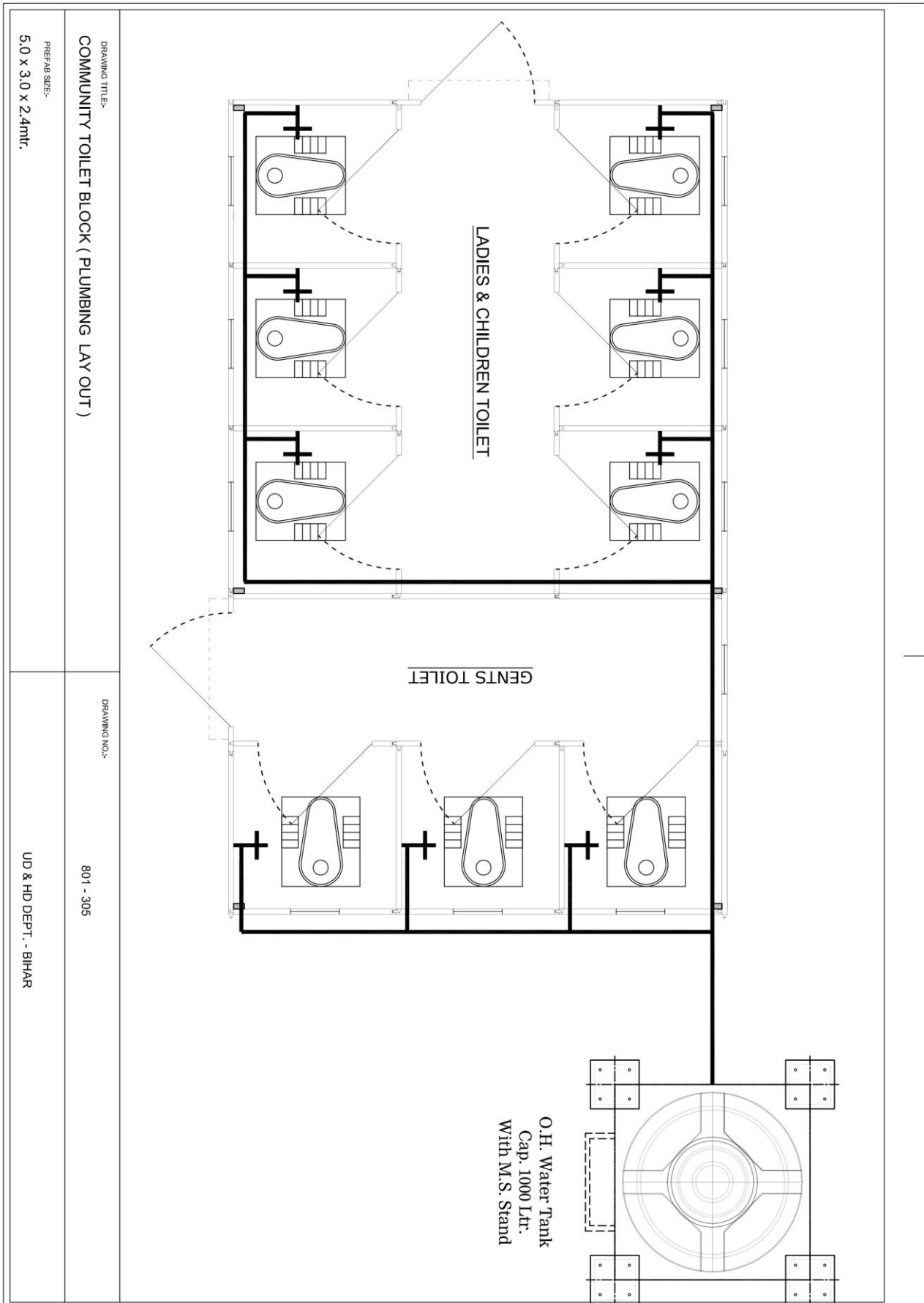

3. Sanitation Layout for (09 Seater) Community Toilets Block for ladies ,Gents and Children.

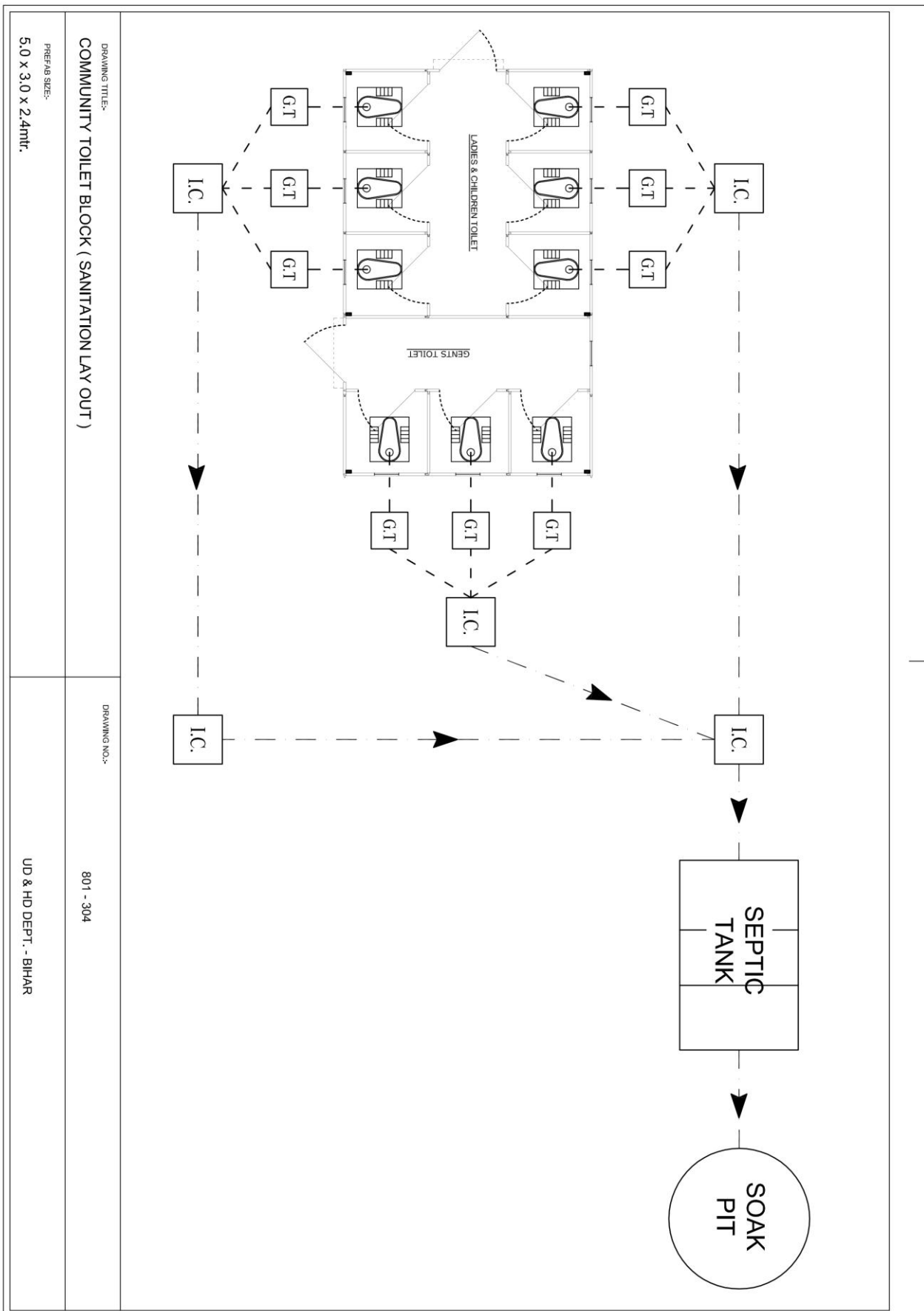

DRAWING TITLE:-
COMMUNITY TOILET BLOCK (SANITATION LAY OUT)

PREFAB SIZE:-
5.0 x 3.0 x 2.4mtr.

DRAWING NO.:-

801 - 304

UD & HD DEPT. - BIHAR

4. Plan of Community Toilets Block (9 Seater) for ladies, Gents and Children.

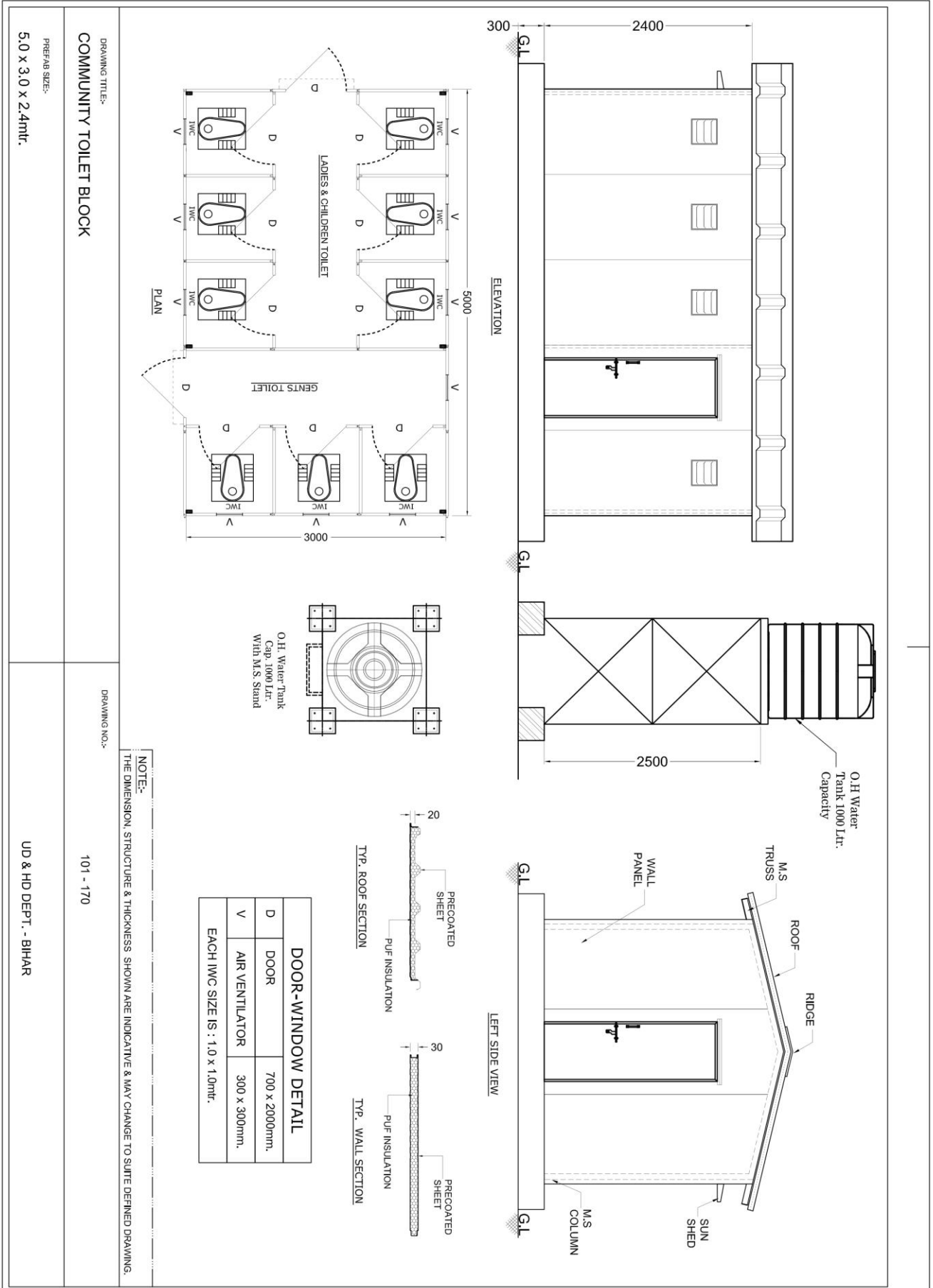

5. Gully Trap of Community Toilets Block (9 Seater) for ladies, Gents and Children.

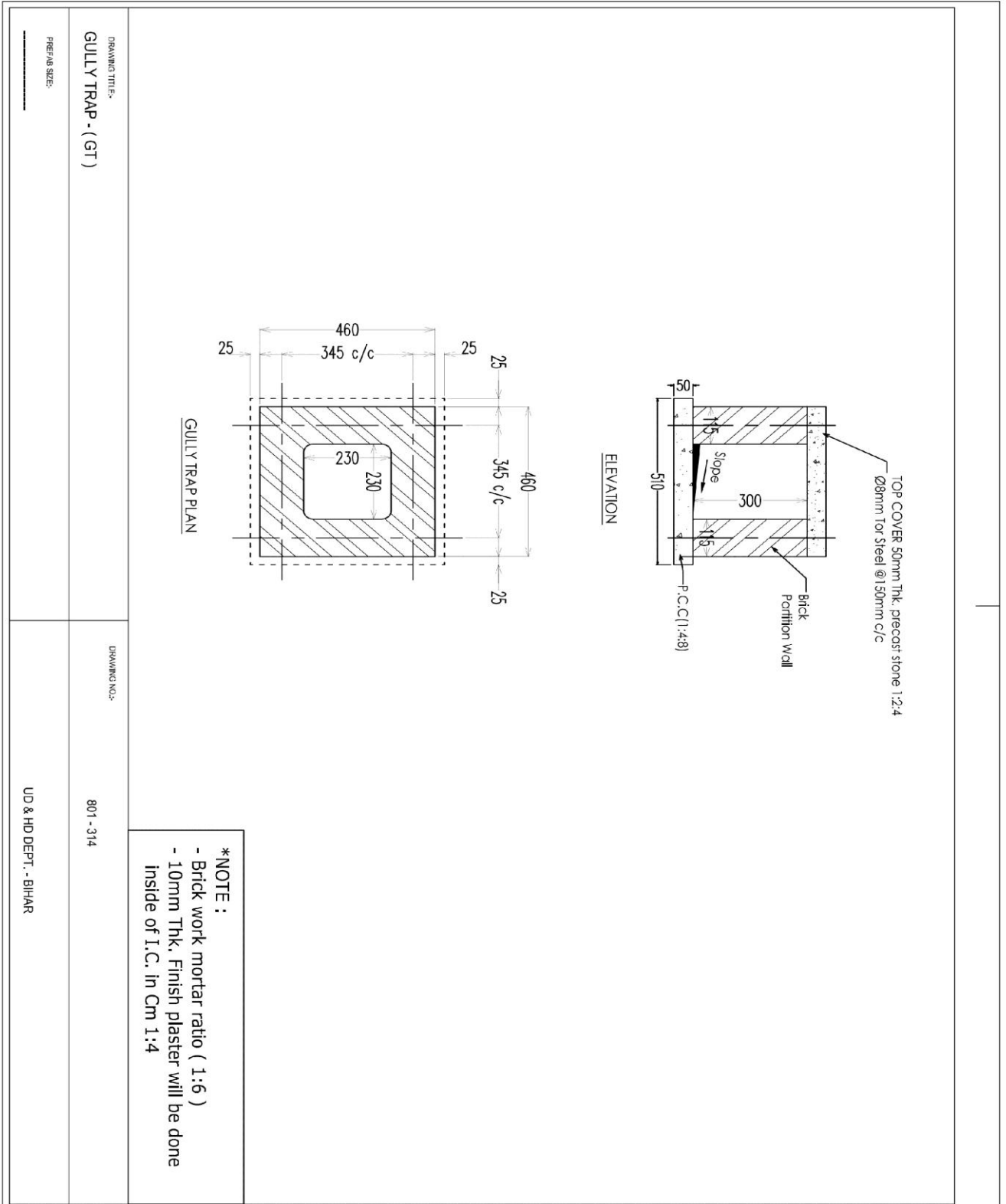

6. Inspection Chamber of Community Toilets Block (9 Seater) for ladies, Gents and Children.

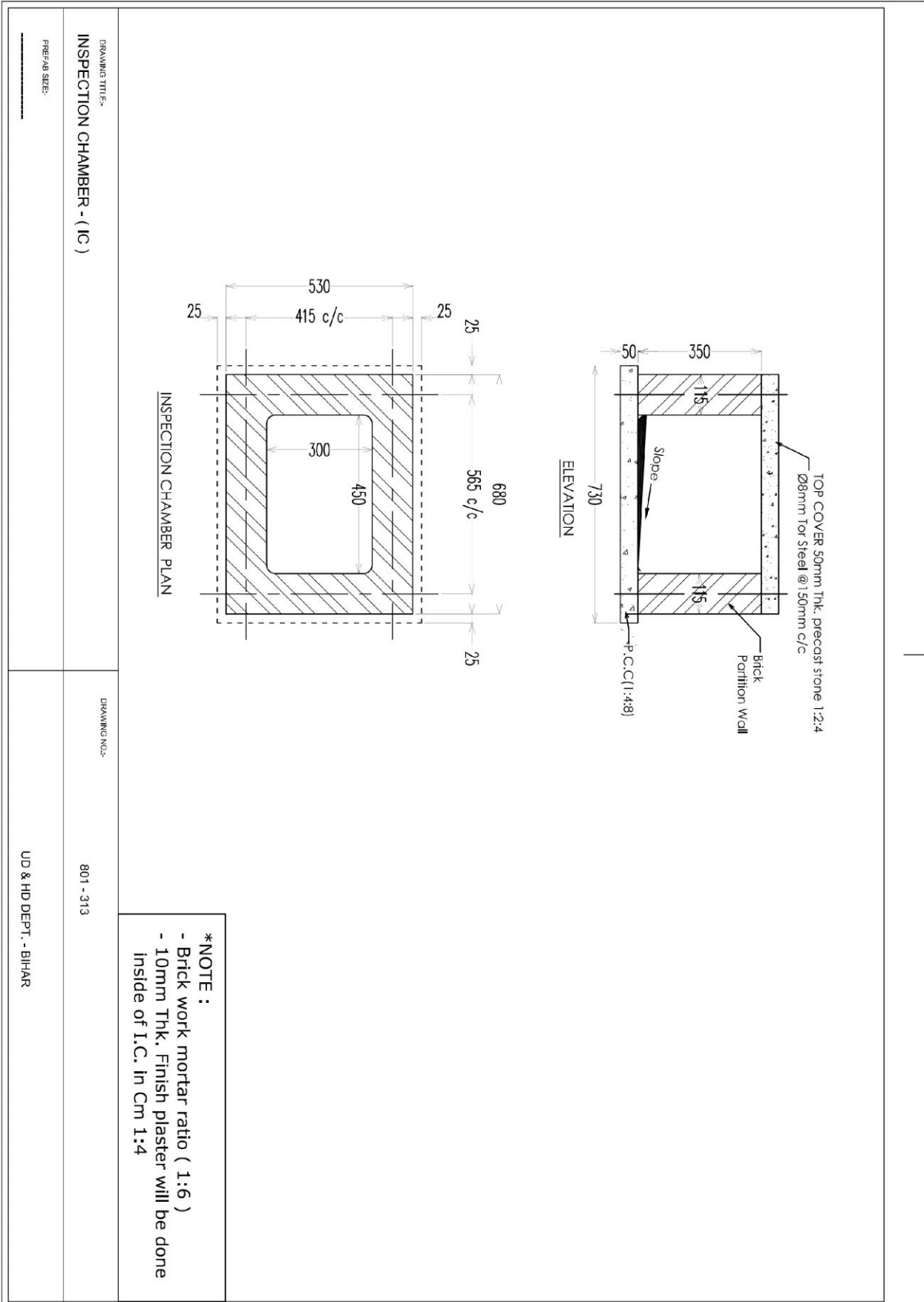

7. **Septic Tank of Community Toilets Block (9 Seater) for ladies, Gents and Children.**

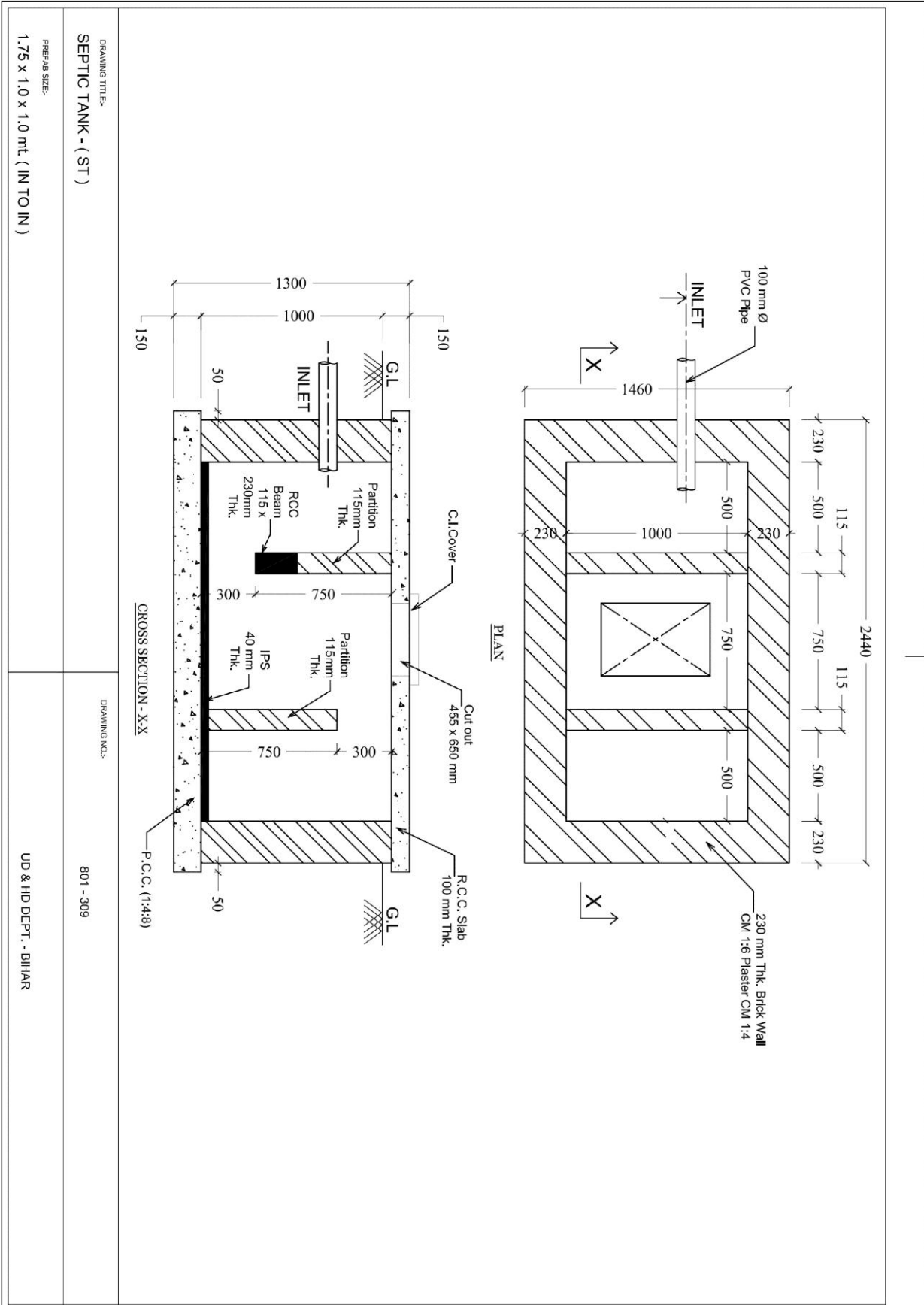

8. Soak pit of Community Toilets Block (9 Seater) for ladies, Gents and Children.

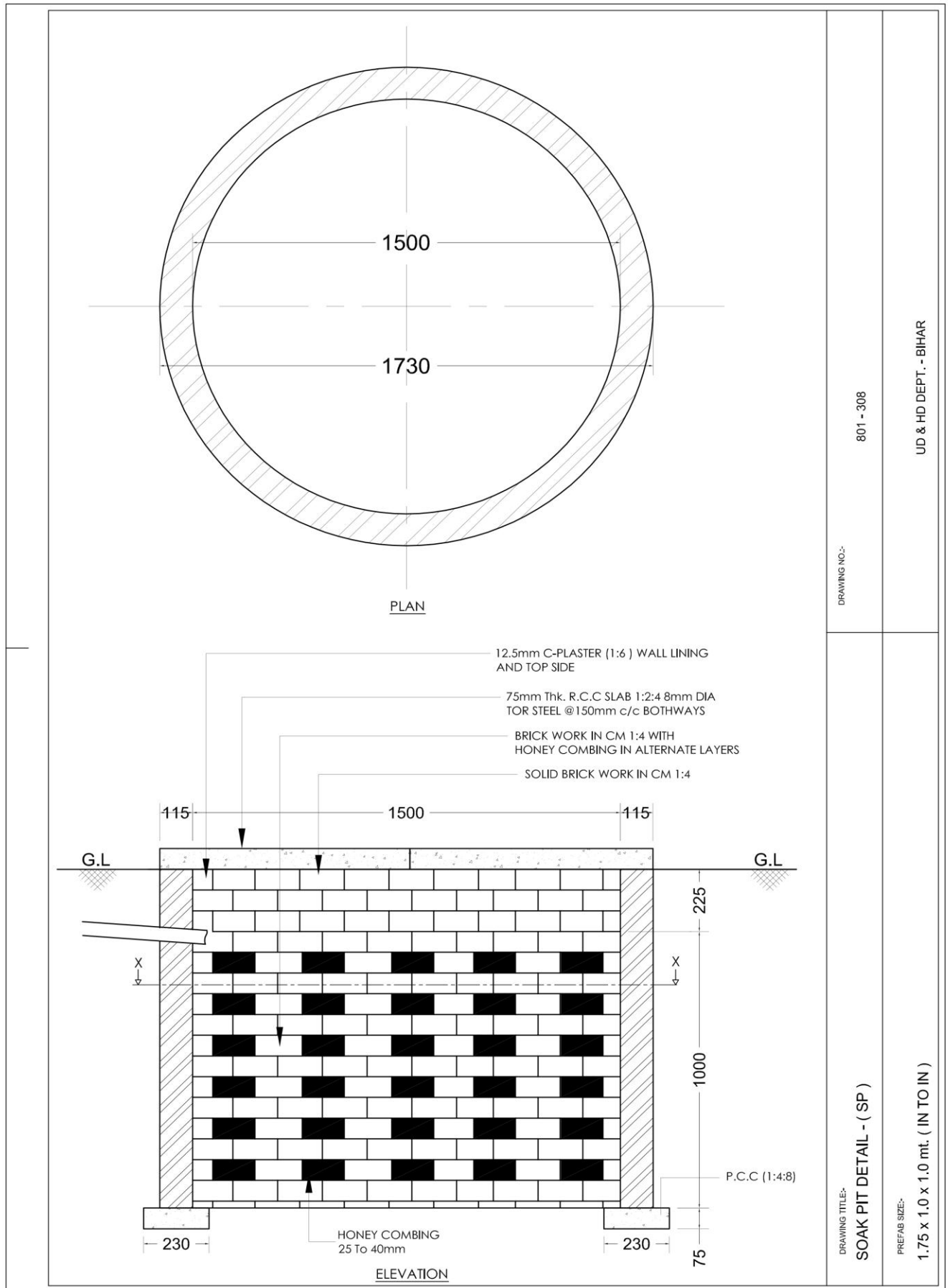

801 - 308

UD & HD DEPT. - BIHAR

DRAWING NO.:-

DRAWING TITLE:-
SOAK PIT DETAIL - (SP)

PREFAB SIZE:-
1.75 x 1.0 x 1.0 mt. (IN TO IN)

3. Public Toilets 12 Seater for Ladies and Gents.

Technical parameters : Foundation Section Details of 12 Seater Public Toilets for Ladies and Gents .

The Section details for the said Supply and construction of Public Toilets for Ladies and Gents with prefabricated materials using Prefabricated Technology will be as follows

Technical Specification – Supply and construction of Public Toilets 12 Seater for Ladies & Gents with prefabricated materials using Prefabricated Technology of “Continuous PUF Sandwich Panel fixed to Tubular Steel Frame”.

TECHNICAL SPECIFICATION FOR PUF INSULATED PREFABRICATED TOILET BLOCK

Description :

The prefabricated toilet blocks shall be suitable for mounting on readymade concrete floor / pillars. The components shall be fabricated at factory for easy to assembly at site.

Size :

a) **Public Toilet (12 Seater) : 5.0 x 3.0 x 2.4 mt (Approx)**

M.S. Structure :

The supported M.S. Structure like column, truss / portal truss, purlin, tie member etc. shall be made out with suitable size rolled / tube / folded sections. The structure shall be painted with One coat of red oxide as primer and two coats of good quality oil paint

PUF Insulated wall :

The insulated walls shall be made of Sandwich panels. The sandwich panels shall be made out of 0.35mm thick Pre coated steel sheet (white colour) on both side of PUF (Polyurethane foam). The total thickness of panel shall be 30mm. The panels are join together by tongue and groove method.

PUF Insulated Roof :

The insulated Roof cladding shall be done with sandwich type panels. The panels shall be made out with 0.35 mm thick Pre coated Profile steel sheet (Teracotacolour) at outer side and 0.35 mm thick Pre coated sheet (White colour) at inner side of PUF (Polyurethane foam). Total thickness of roof panel shall be 20 mm. Suitable ridge shall be made out from Pre coated steel sheets. The roof shall have minimum projection of 0.3m from the eaves wall and 0.15m from the gable walls.

Door :

The door frame shall be made out with MS Folded section. The shutter shall be made out with Pre coated steel sheets both side of PUF as per wall panel. The door shutter shall be fixed with the door frame with hinges. The door shutter shall be provided with 1 No. aldrops at outside, 1 no. Tower bolts at the center inside and handles shall be provided on both the sides. The size of door shall be as per mention in drawing.

Air Ventilator :

The air ventilator shall be made out from readymade Aluminum Adjustable louvers type channels and it will be fixed in the wall panels with suitable fasteners. Suitable plain glass shall be provided as a louvers. The size of air ventilator shall be as per mention in the drawing.

Other Details is Below:-

1. Technical parameters: Foundation Layout For O.H Water Tank Plan Details of (12 seater Public Toilets) for Ladies and Gents.

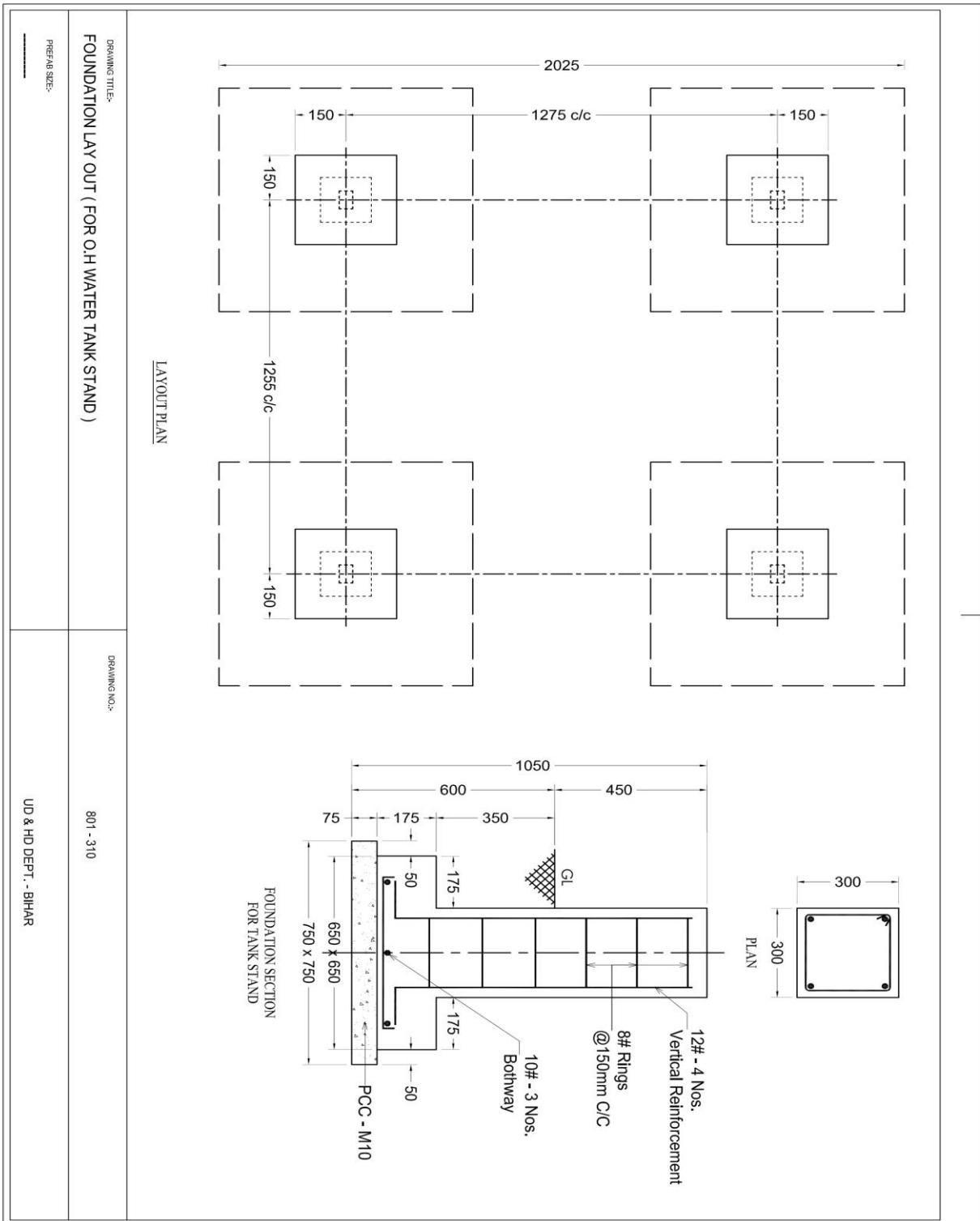

9. Technical parameters: Electrical Layout of (12 seater Public Toilets) for Ladies and Gents.

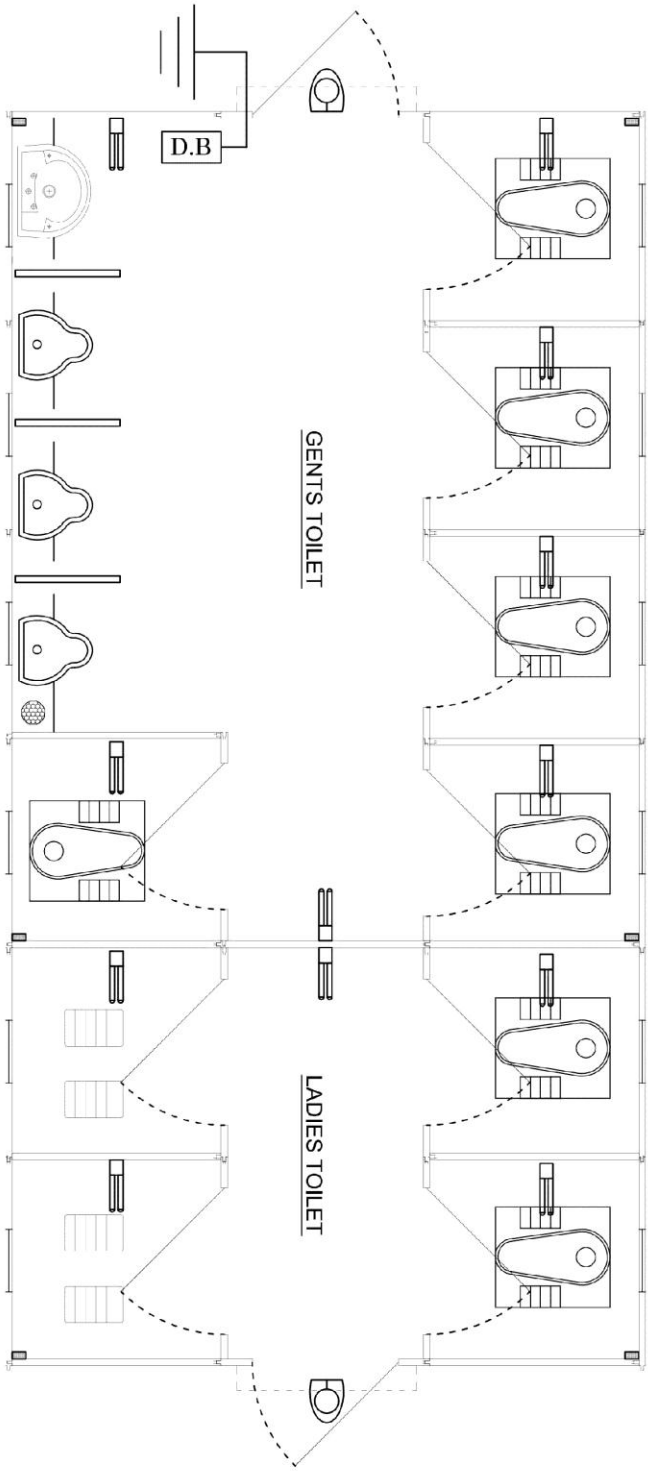

Symbol	Electrical Detail	Qty.
	CFL Light (11 Watt)	12 Nos.
	Bulkhead Fitting	02 Nos.
	Distribution Board WITH MCB	01 Job.
	G.I Earthing With Pit	01 Job.

DRAWING TITLE:-
PUBLIC TOILET BLOCK (ELECTRICAL LAY OUT)

PREPARED SIZE:-
6.0 x 3.0 x 2.4mt.

DRAWING NO:-
801 - 312

UD & HD DEPT. - BIHAR

10. Technical parameters: Foundation Lay Out of (12 seater Public Toilets) for Ladies

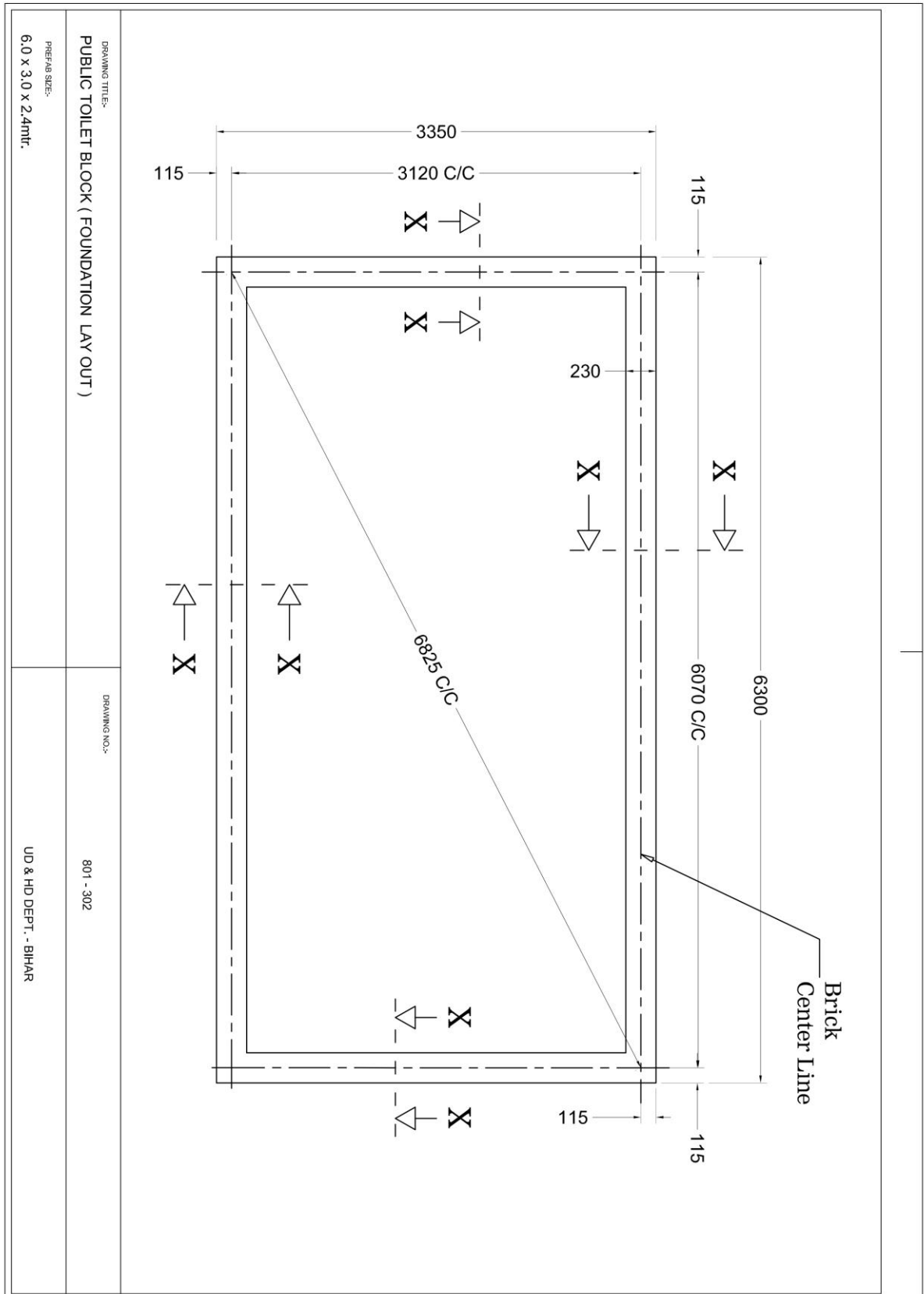

Gents.

11. Technical parameters: Plumbing Lay Out of (12 Seater Public Toilets) for Ladies and Gents

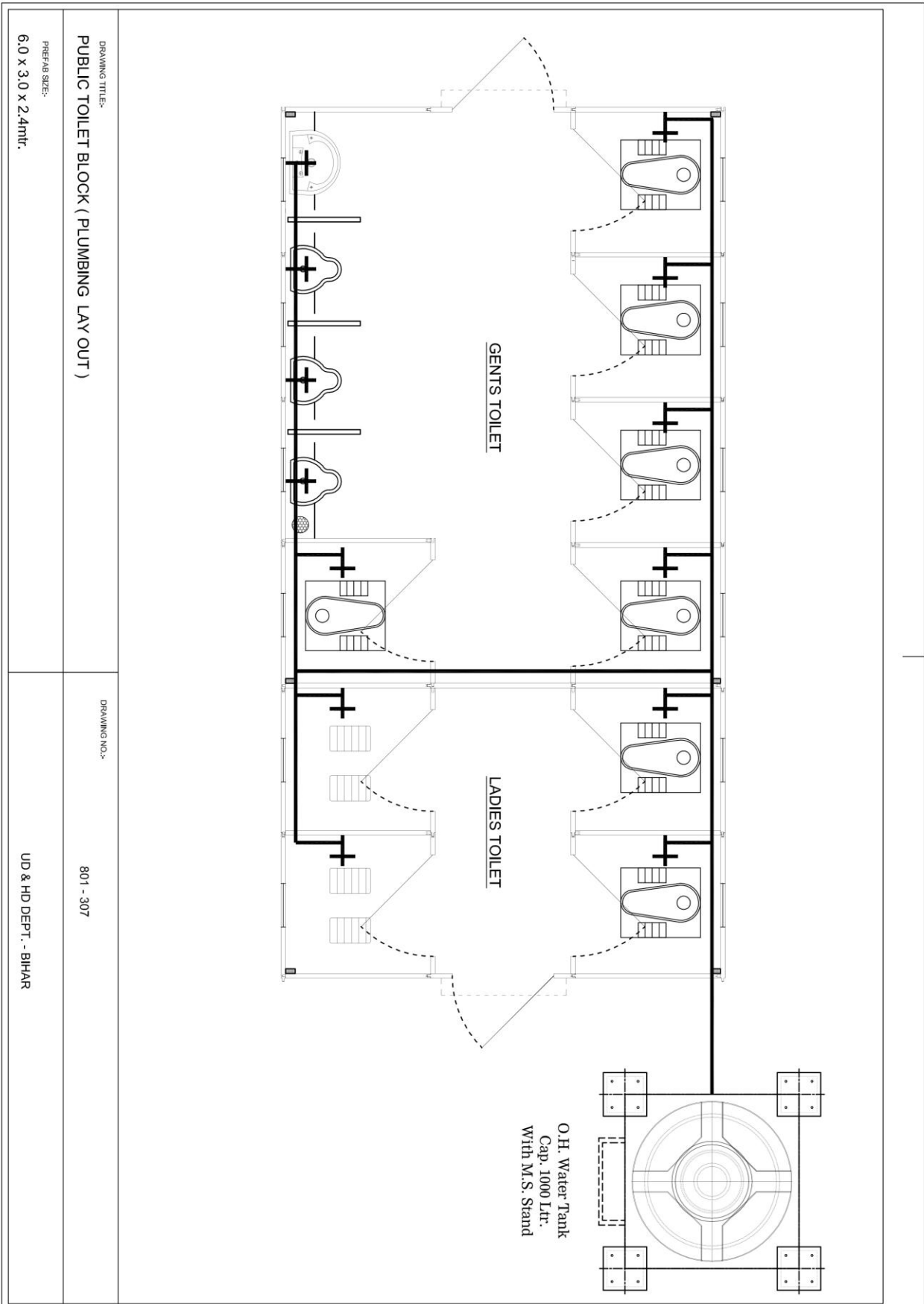

12. Technical parameters: Sanitation Lay Out of (12 seater Public Toilets) for Ladies and Gents.

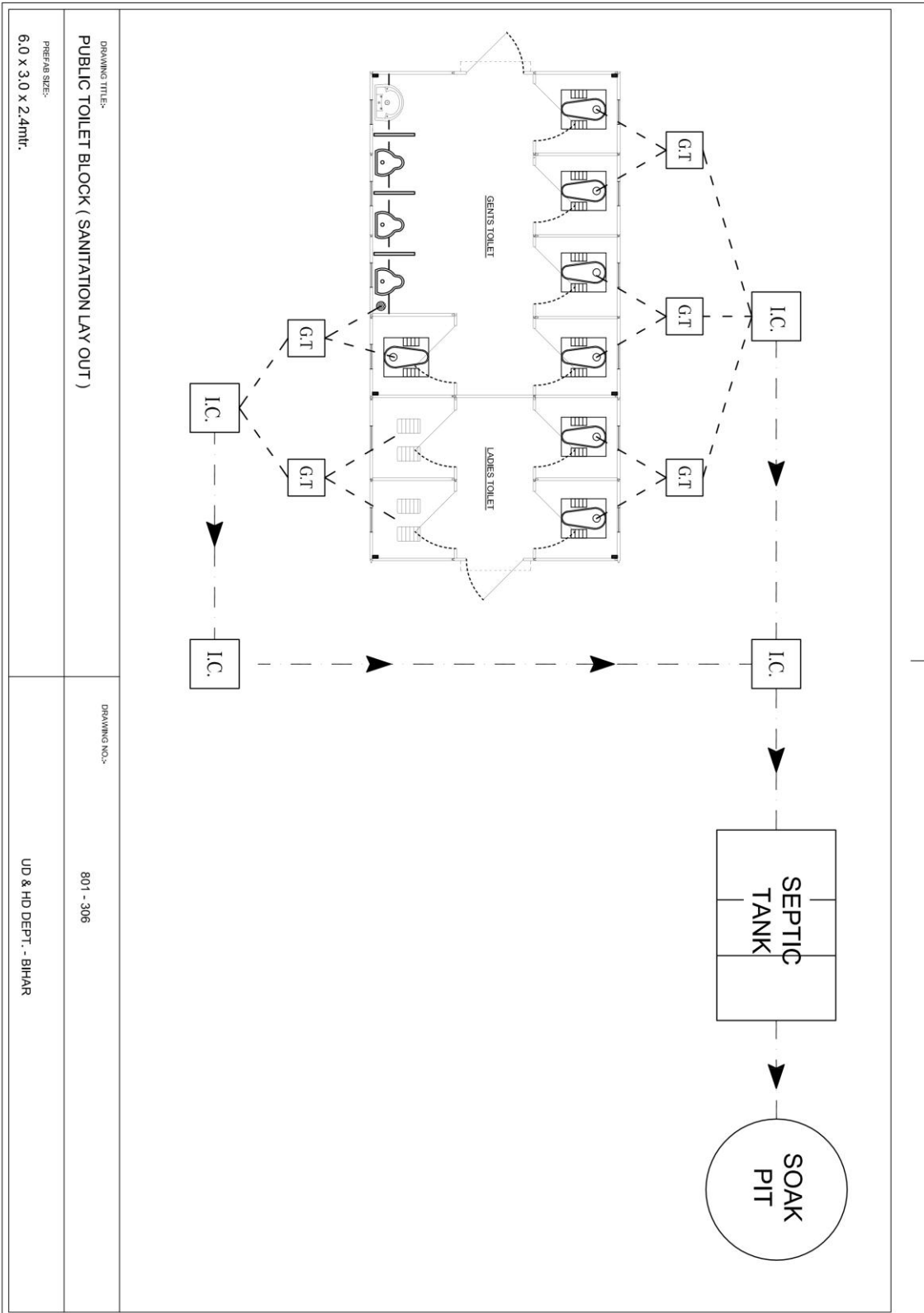

DRAWING TITLE:-
PUBLIC TOILET BLOCK (SANITATION LAY OUT)

DRAWING NO.:-

801 - 306

PREFAB SIZE:-
6.0 x 3.0 x 2.4mtr.

UD & HD DEPT. - BIHAR

13. Technical parameters: Plan Public Toilet Block of (12 Seater Public Toilets) for Ladies and Gents.

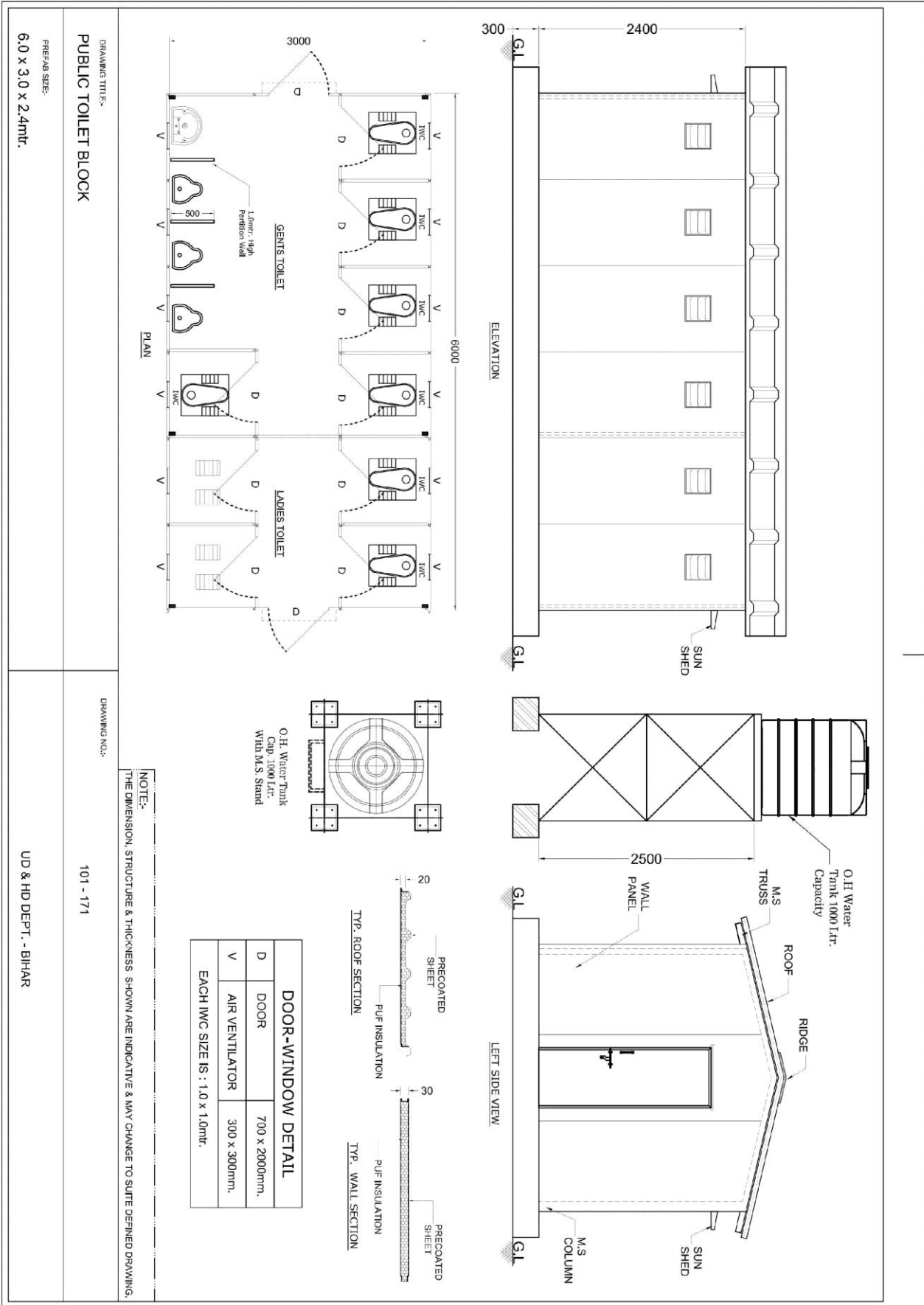

A. Sanitation parameters: Gully Trap of (12 Seater Public Toilets) for Ladies & Gents .

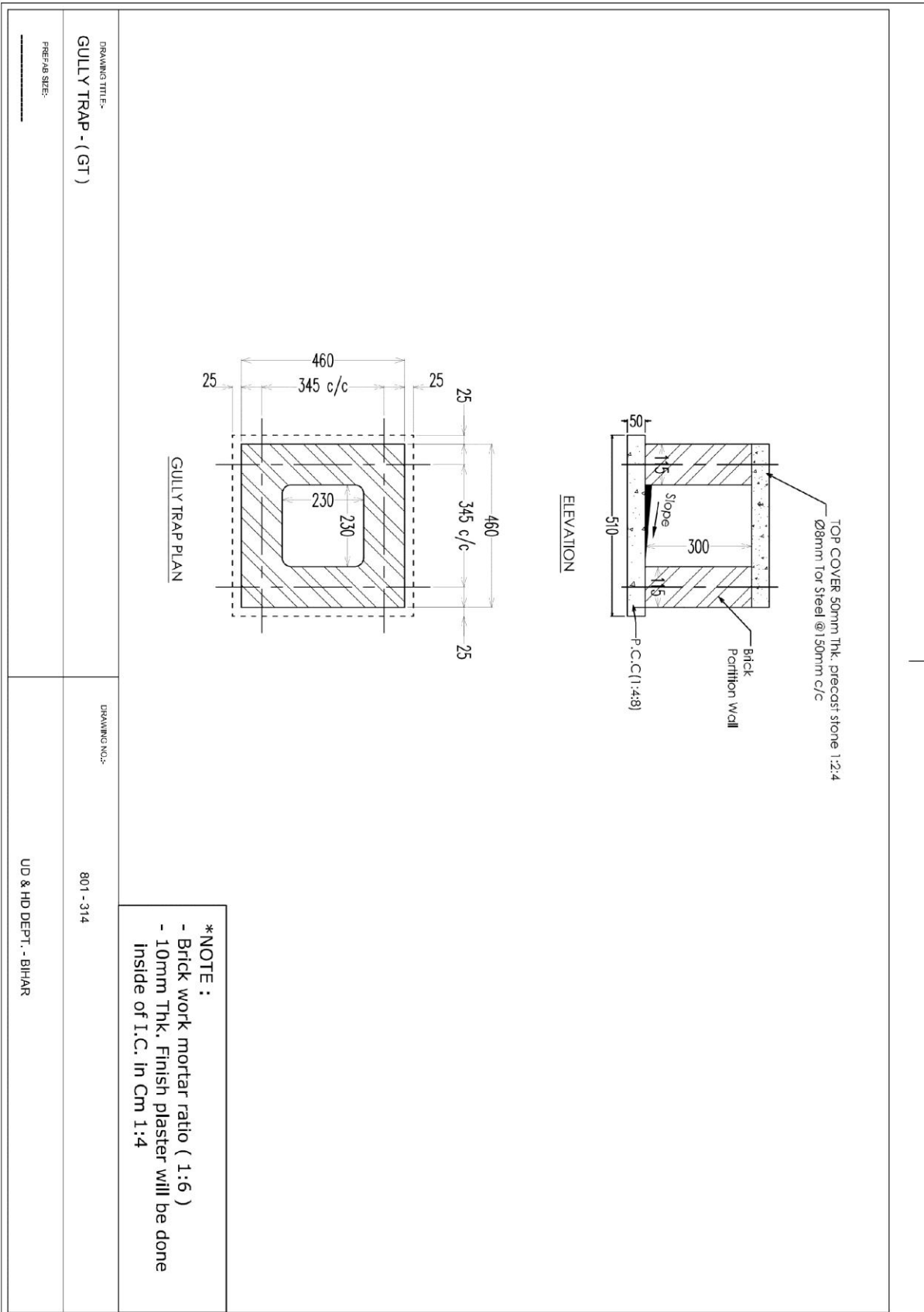

B. Sanitation parameters: Inspection Chamber of (12 Seater Public Toilets) for Ladies for Gents

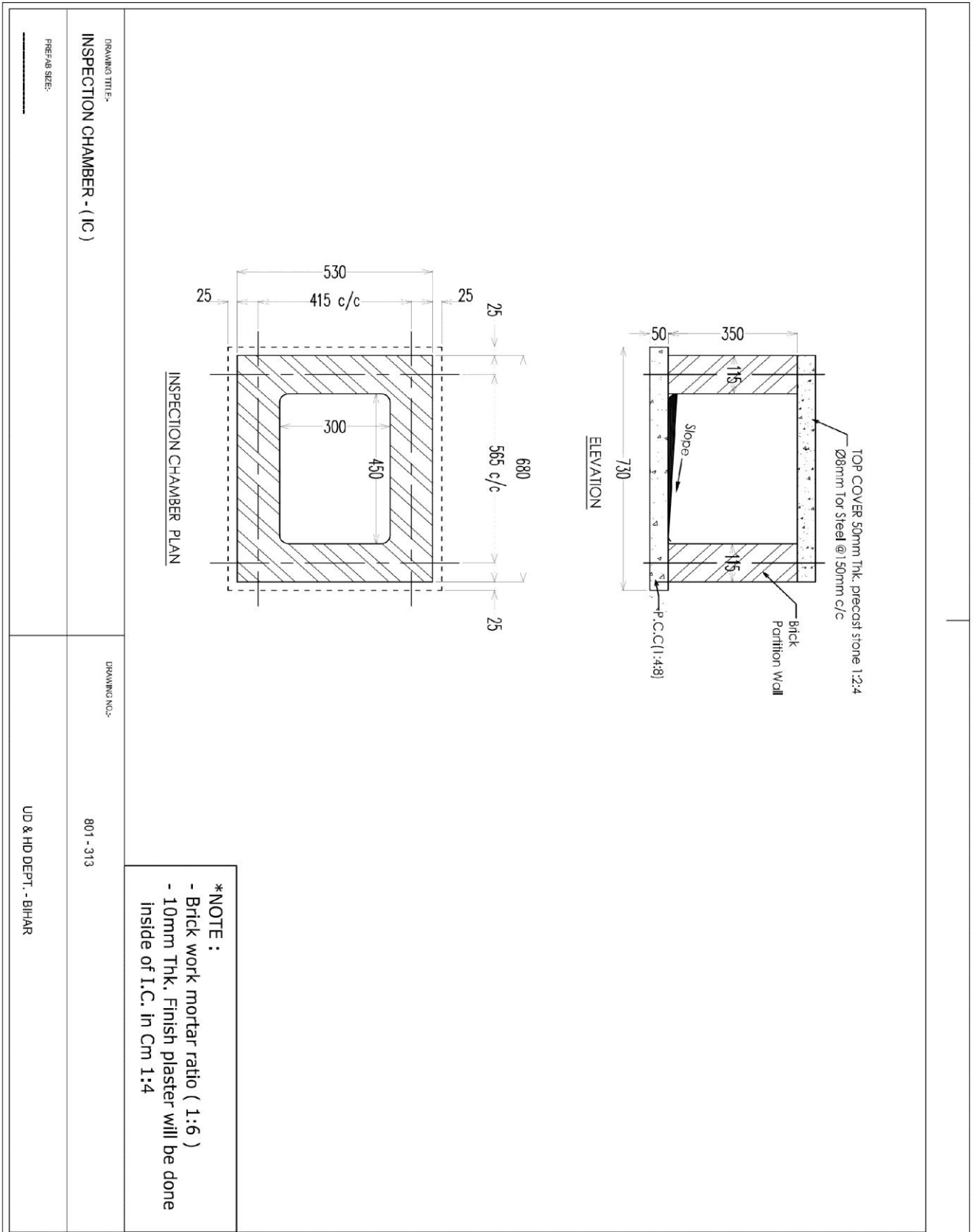

C. Sanitation parameters: Septic Tank of (12 Seater Public Toilets) for Ladies & Gents.

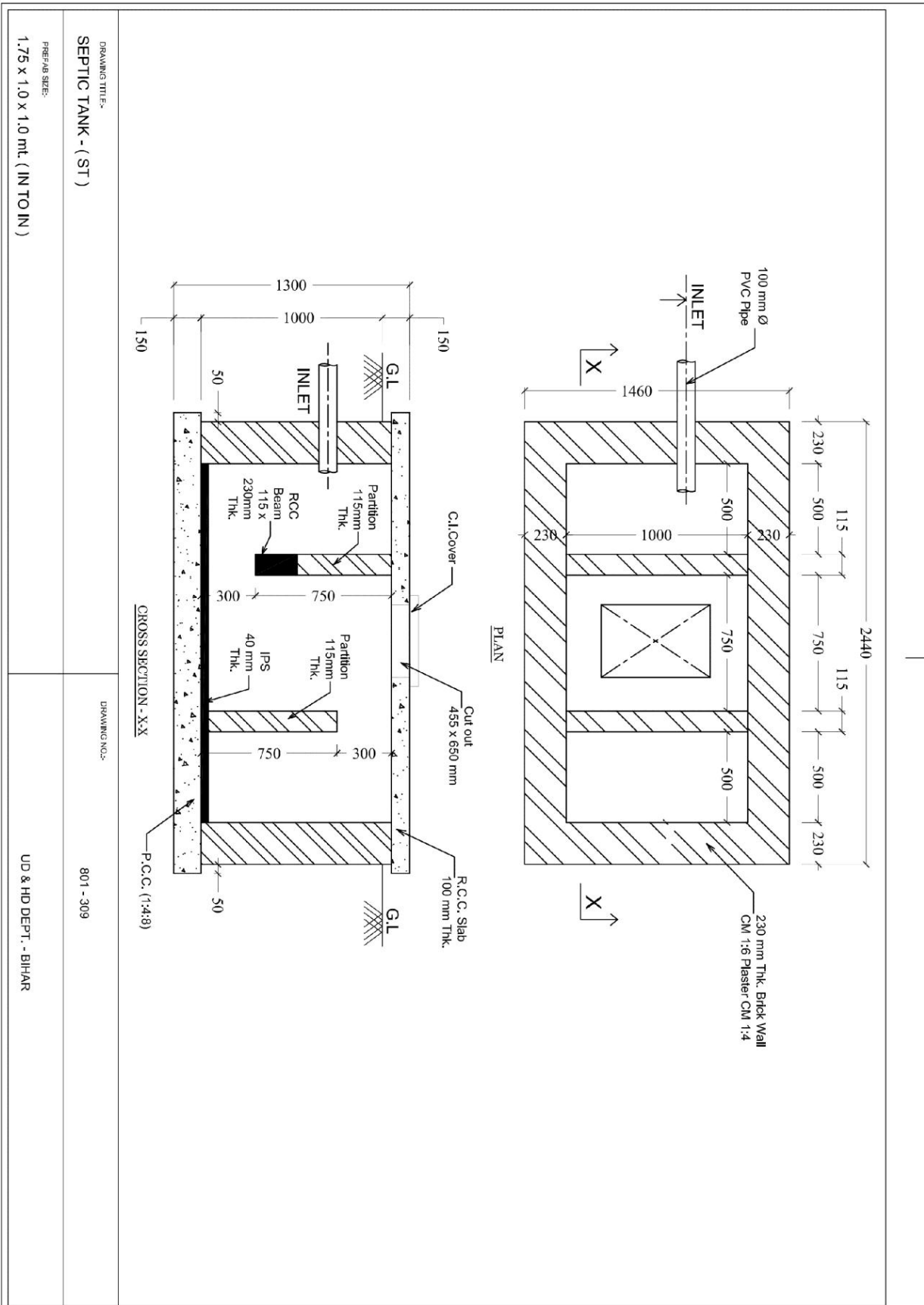

D. Sanitation parameters: Soak Pit of (12 seater Public Toilets) for Ladies & Gents .

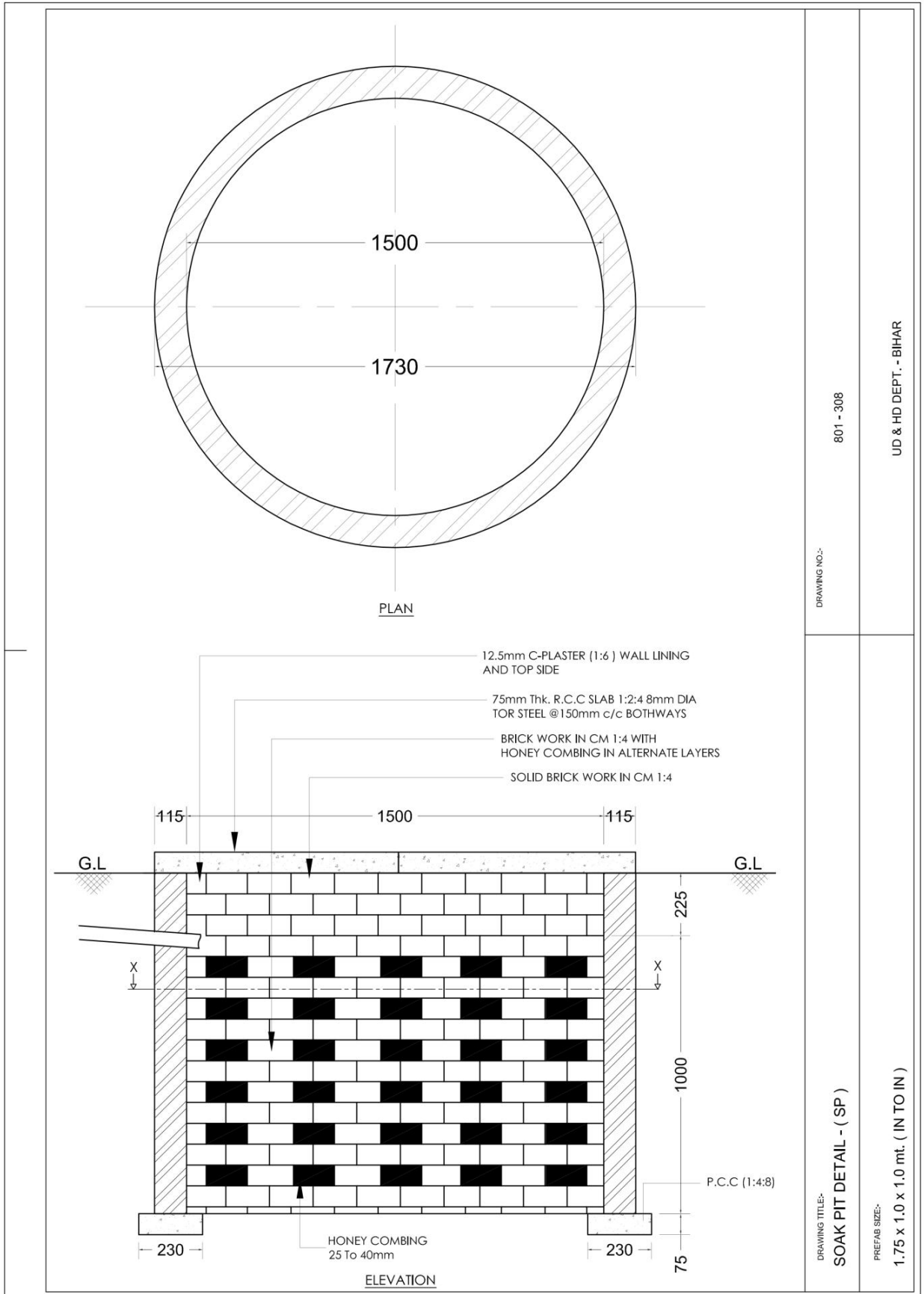

DRAWING NO:- 801 - 308

UD & HD DEPT. - BIHAR

DRAWING TITLE:- SOAK PIT DETAIL - (SP)

PREFAB SIZE:- 1.75 x 1.0 x 1.0 mt. (IN TO IN)